

STYROFOAM WALLMATE XPS
SLOTTED EDGE INSULATION

Insulate basement walls from the inside.

STYROFOAM™ WALLMATE™ XPS slotted edge insulation is specially designed to insulate basement walls from the inside. STYROFOAM WALLMATE XPS insulation has an R-value** of 5.0 per inch and resists moisture, keeping your basement comfortable all year long. It is quick and easy to install directly on masonry walls.

The following procedures are recommended for fast and easy installation of STYROFOAM WALLMATE XPS insulation.

Before installing STYROFOAM WALLMATE XPS insulation on the interior basement wall, be sure there are no leaks or structural cracks in the wall. STYROFOAM WALLMATE XPS insulation insulates the basement wall; it does not stop water leakage.

Measuring And Cutting

- To measure, mark board by dragging measuring tape hook along the surface of a board while holding the other end of the tape at the desired measurement (Figure 1).

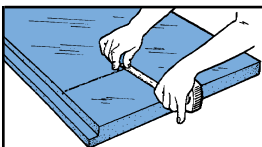

Figure 1

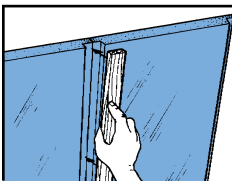

Figure 2

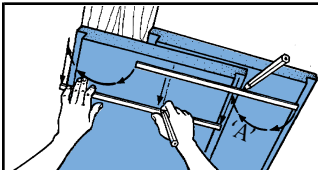

Figure 3

- To cut, hold utility knife low against the board and make a deep impression. There is no need to cut all the way through.
- Break board over the edge of a table.

Installation

- Position boards of STYROFOAM WALLMATE XPS insulation vertically against wall, ensuring they are plumb at right angles (90 degrees).
- Place a 1" x 3" furring strip into the slot between two adjoining boards (Figure 2).

Option: Using a 2" x 3" furring strip will provide an air space behind drywall for installation of electrical wiring.

- With electric drill and masonry bit, drill holes through furring strips 1-1/2" into concrete wall. Concrete fasteners should be 1-1/4" longer than the insulation board thickness. (To secure board to wall, use three or four screws per 8' length of furring strip.)

Option: STYROFOAM WALLMATE XPS insulation can be installed horizontally with furring strips running every 2'.

Measuring For Exact Fit

- STYROFOAM WALLMATE XPS insulation can be installed in tight spaces, even if the wall is uneven. Position insulation board squarely against corner, overlapping inside edge of last board installed (Figure 3).
- Using a 2'-long stick, measure from the outside edge of the last board installed to the outside edge

MATERIALS CHECKLIST

To install STYROFOAM WALLMATE XPS insulation, you need:

- Cut-proof gloves
- Measuring tape
- Level
- Hand saw
- Utility knife
- Hammer
- 1" x 3" Furring strips
- Electric drill
- Masonry bits, screwdriver bits
- Masonry nails and screws, such as Tapcon screws
- Drywall
- Drywall screws
- Outlet boxes
- Electrical wire, wire staples
- Polystyrene-compatible interior caulk, caulking gun
- Polystyrene-compatible spray foam adhesive, such as GREAT STUFF™ polyurethane foam sealant
- Safety glasses

of the new board (distance 'A'). Mark 'A' on stick.

- Place stick against wall. With a pencil at 'A,' move it down the board to be cut.
- Cut along marked line.
- Install overlap piece in corner.

Electrical Outlets

- Cut a block of wood the same size as the electrical outlet box. Block thickness should ensure that the edge of the electrical outlet box will be flush with the drywall. Fasten wood block onto concrete wall with concrete fasteners.
- Place insulation board over wood block and tap firmly with hand, forming an imprint of the block on the back side of the insulation board. Turn board over and cut out imprint. (Figure 4).

©™Trademark of The Dow Chemical Company ("Dow") or an affiliated company of Dow
**R-value means resistance to heat flow. The higher the R-value, the greater the insulating power.

- To accommodate electrical wires, cut 1/2"-deep channel on the back of the insulation board with utility knife (Figure 5). Use electrical staples to hold wires in place.

Caution: Some localities do not allow homeowners to do their own electrical work. In others, a permit is required. Check your local building code for rules and regulations. Dow recommends that electrical work be done by qualified individuals only.

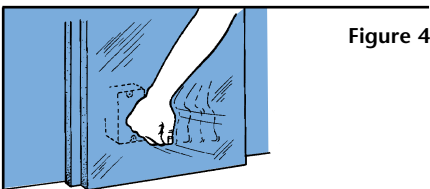

Figure 4

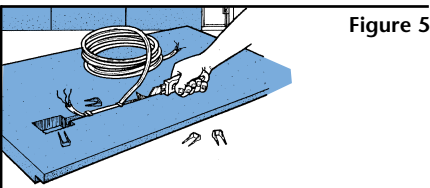

Figure 5

Plumbing Fixtures

To install STYROFOAM WALLMATE XPS insulation around plumbing fixtures protruding from the wall, ensure furring strips are positioned on either side of the pipe. Trim slotted edge of insulation board to ensure the next furring strip is on 24" centers. For areas behind plumbing that cannot be filled with STYROFOAM WALLMATE XPS insulation, fill with polystyrene-compatible spray foam insulation.

Windows And Doorways

- Extend window and door framing so it will be flush with finishing drywall.
- Place STYROFOAM WALLMATE XPS insulation against window or door frame and tap (as with electrical outlet), making an imprint of the area to be cut on the back side of the board (Figure 6).



Figure 6

- Turn board over and cut out imprint.
- Seal the space between STYROFOAM WALLMATE XPS insulation and the window or door frame with polystyrene-compatible caulk.

Corners

STYROFOAM WALLMATE XPS insulation can be installed to the outside or inside edge at corners of interior basement walls.

OUTSIDE (Figure 7)

- Press drywall corner bead over outside corner of wall covered with STYROFOAM WALLMATE XPS insulation.
- Attach first drywall sheet flush to the corner, using drywall screws to fasten to corner bead.
- Install second drywall sheet to cover end of first sheet.
- Fasten to other flange of drywall corner bead.

- For wall finishing, install second drywall corner bead over drywall corner by fastening with drywall screws to first corner bead.

INSIDE (Figure 8)

- Press a drywall corner bead into inside corner formed by boards of STYROFOAM WALLMATE XPS insulation.
- Butt first drywall board into corner, and fasten to corner bead flange using drywall screws.
- Butt second drywall board to first, and fasten to other corner bead flange using drywall screws.

Install Drywall

With furring strips 2' apart around room perimeter, installing drywall over STYROFOAM WALLMATE XPS insulation is fast and simple.

Use a wedge to lift the bottom of the drywall from floor before fastening. This will protect the drywall from incidental water on the basement floor.

Tape and finish drywall according to manufacturer's directions.

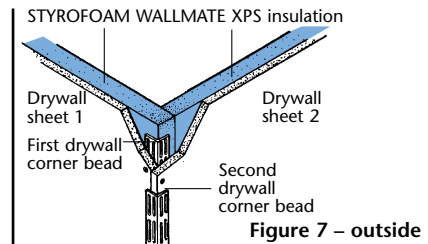

Figure 7 - outside

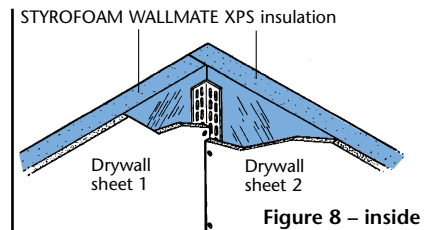

Figure 8 - inside

IN THE U.S.:

- For Technical Information: 1-866-583-BLUE (2583)

THE DOW CHEMICAL COMPANY

- Building & Construction • 200 Larkin • Midland, MI 48674 • www.insulateyourhome.com

NOTICE: No freedom from any patent owned by Dow or others is to be inferred. Because use conditions and applicable laws may differ from one location to another and may change with time, Customer is responsible for determining whether products and the information in this document are appropriate for Customer's use and for ensuring that Customer's workplace and disposal practices are in compliance with applicable laws and other government enactments. Dow assumes no obligation or liability for the information in this document. NO WARRANTIES ARE GIVEN; ALL IMPLIED WARRANTIES OF MERCHANTABILITY OR FITNESS FOR A PARTICULAR PURPOSE ARE EXPRESSLY EXCLUDED.

COMBUSTIBLE: Protect from high heat sources. Local building codes may require a protective or thermal barrier. For more information consult MSDS, call Dow at 1-866-583-BLUE (2583) or contact your local building inspector. In an emergency, call 1-989-636-4400.

Building and/or construction practices unrelated to insulation could greatly affect moisture and the potential for mold formation. No material supplier including Dow can give assurance that mold will not develop in any specific system.

Code Compliance for STYROFOAM WALLMATE XPS Insulation

- ASTM C578 Type X
- Meets IBC/IRC requirements for foam plastic insulation
- ICBO-ES ER 2257
- BOCA-ES RR 21-02
- SBCCI PST & ESI ER 9576D



Living.
Improved daily.™

